



MP 58909 (series 58750-59249), built 9-36 by AC&F, repainted and reweighed DES. 6-49. *Missouri Pacific photo, Joe Colias collection.*



MP 60135 (series 58750-59249), built 11-41, reweighed SA 8-56. Beginning in mid-1949, the MP started using this 42" emblem and slogan. *Ed Hawkins collection.*



Enterprise Equipment for Hopper Coal Cars

Enterprise Type D Door Operating Mechanism

The Enterprise Type D Door Operating Mechanism illustrated in Fig. 2.621 provides an efficient door locking means and insures a close fitting door free from leakage even when car is loaded with coal dust or other fine materials. The mechanism forms a positive lock, is adjustable and a pair of doors are safely and conveniently operated from one side of

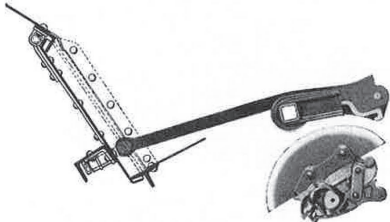

Fig. 2.621—Enterprise Type D Door Operating Mechanism

the car. For application see Fig. 3.226, page 475. There is also a special type D mechanism operative from either side of car.

Enterprise Unit Door Latch

The Enterprise Unit Door Latch illustrated in Fig. 2.623 has met with much favor by coal dealers and others who find it expedient to open only one door

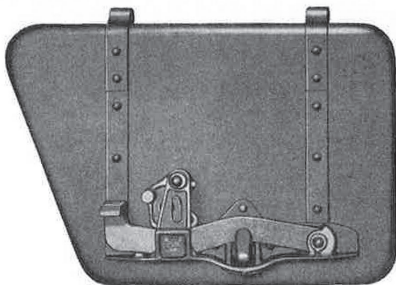

Fig. 2.623—Enterprise Unit Door Latch

at a time rather than a pair of doors as they can thereby better control the discharge of the load upon the conveying machine. Each door is separately locked by a latch of strong and efficient design which holds it in very close relationship to the hopper frame and the finest of materials may be hauled without leakage. Each door is operated as a separate unit from its respective side of car.

Enterprise Hoppers and Frames

The Enterprise hopper included in General car drawing page 260 is a slightly modified form of the A.A.R. Hopper. The Hopper Frames are of Ship Bulb section Copper Bearing Steel which provide smooth and true surfaces for the fit of the door and an



Fig. 2.622—Enterprise Bulb Section Hopper Frame

enduring quality for wear. For Hopper and frame applications see Figs. 3.225 and 3.226, page 475. For detail of Frame see Fig. 3.221, page 474. For Enterprise T section Copper Bearing Steel Frame for A.A.R. Hopper, see Fig. 3.222, page 474.

Enterprise Cast Steel Body Foundations

The Enterprise Cast Steel Body Foundations illustrated in Fig. 2.624 save weight and reduce car parts; combining in a single unit a real foundation for withstanding shocks received from draft impact, dead weight of load and the upward pounding of the trucks. For applications see pages 466 and 467.

For other products see pages 239 and 289.

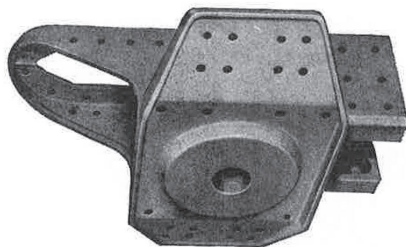

Fig. 2.624—Enterprise cast steel body foundation

ENTERPRISE RAILWAY EQUIPMENT COMPANY, 59 E. Van Buren St., CHICAGO, ILL.

Other Products and Branch Offices Are Listed in the Classified Indexes

Sec. 2—261

Enterprise Type D Mechanism for Hopper Coal Cars

THE Enterprise Type D Door Operating Mechanism as illustrated provides an efficient door locking means and insures a close fitting door free from leakage. The mechanism forms a positive lock, is easily adjustable and a pair of doors is safely and conveniently operated from one side of the car. There is also a Special Type D Mechanism operative from either side of the car.

For Application see Page 401.

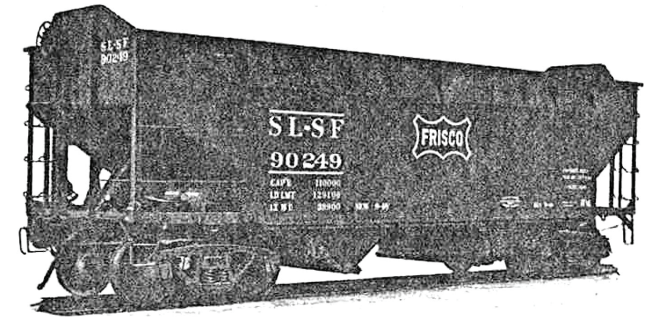

All Steel 55-ton Hopper Car equipped with Enterprise Type D Door Mechanism

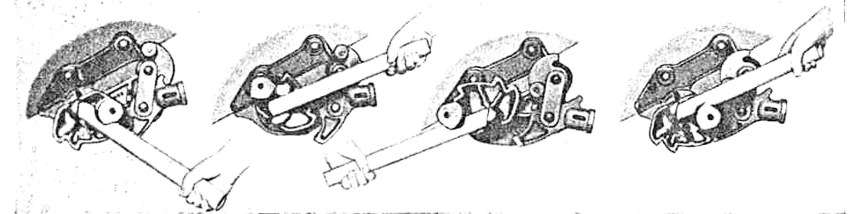

To Open Open To Close Closed
Operating a Type D Door Locking Mechanism

The Type D Door Operating Mechanism is easily operated with a bar. Note the notches which can be engaged by the pawl to allow a controlled discharge of coal or ballast, with door opening of approximately 5 in. or 10 in. in addition to the full 24 in. opening.

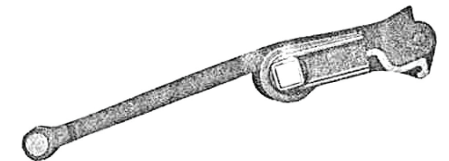

Enterprise Type D Door Operating Mechanism

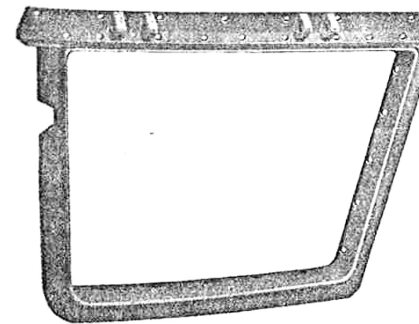

Enterprise T Section Frame

This feature is exclusive with the Type D mechanism.

The Enterprise Type D Door Operating Mechanism in combination with the Enterprise T Section Frame as illustrated makes an unusually tight door closure. This insures carrying the finest ladings without loss.

Note from the illustration that all rivets are placed on the inside flange of the frame so the hopper door closes over an absolutely smooth surface.

ENTERPRISE RAILWAY EQUIPMENT COMPANY, 59 E. Van Buren St., CHICAGO 5, ILL.

Products and Branch Offices Are Listed in the Classified Indexes

1949 & 1951 Car Builders Cyclopedias, Simmons-Boardman Publishing Company.